

FOR LEASE | FORMER BANK WITH DRIVE-THRU

811 Canandaigua Road, Geneva, New York



COMMERCIAL REAL ESTATE SALES | LEASING | CONSULTING | DEVELOPMENT | MANAGEMENT



PROPERTY HIGHLIGHTS

Available Space: 2,000 ± SF

Parking Spaces: 800 ± surface lot with cross easements

Zoning: Commercial – Town Center Arterial

Tax Parcel ID: 104.00-1-3.110

Lease Price: \$66,000.00 Annually NNN

CAM/INS/Taxes: Tenant

Comments: Freestanding bank building located on a pad site out front of Lake Geneva Shopping Center anchored by Big Lots. Located along the prime retail corridor of Route 5 & 20. Drive thru accessibility.

[READY TO MAKE A DEAL? CLICK HERE NOW!](#)



Dominic Pavia, President
Licensed Real Estate Broker
315.736.1555 x300 Office
Dpavia@PaviaRealEstate.com



Kevin Valenti
Licensed Associate Real Estate Broker
315.736.1555 x 303
kvalenti@PaviaRealEstate.com



5 Oxford Road
New Hartford, New York 13413

151 Northern Concourse
Syracuse, New York 13212

PaviaRealEstate.com
MAIN: 315.736.1555

FOR LEASE | FORMER BANK WITH DRIVE-THRU

811 Canandaigua Road, Geneva, New York



COMMERCIAL REAL ESTATE SALES | LEASING | CONSULTING | DEVELOPMENT | MANAGEMENT



LATITUDE

42.85672

LONGITUDE

-77.01208

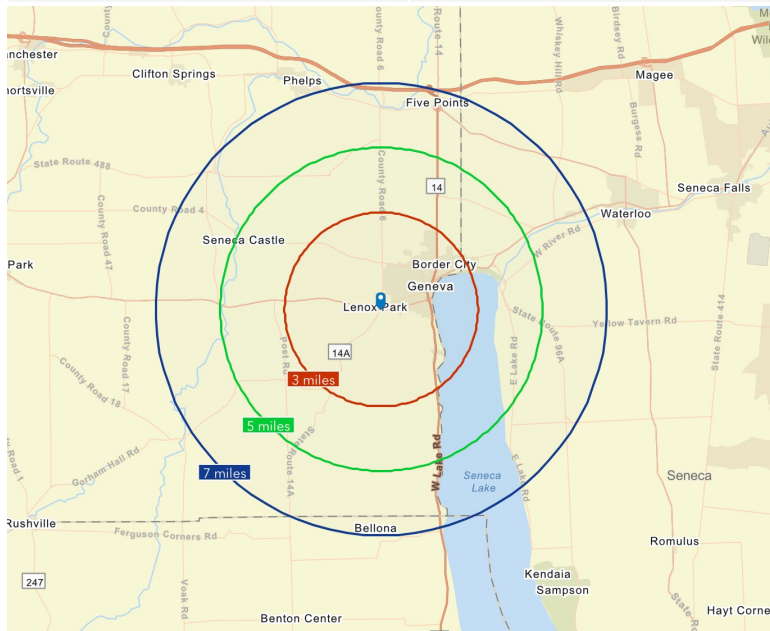

DEMOGRAPHICS

By Radius	3 Mile	5 Mile	7 Mile
Population	16,563	20,209	25,632
Households	6,495	8,002	10,203
Median HH Income	\$51,760	\$54,038	\$55,785
Daytime Population	18,066	21,193	25,699
Businesses	766	900	1,032
Employees	11,976	13,210	14,507

SOURCE: ESRI Report 1/21/2021

TRAFFIC COUNTS

Roadway	Volume Count
Canandaigua Road	16,661 AADT



5 Oxford Road
New Hartford, New York 13413

151 Northern Concourse
Syracuse, New York 13221

PaviaRealEstate.com
MAIN: 315.736.1555

FOR LEASE | FORMER BANK WITH DRIVE-THRU

811 Canandaigua Road, Geneva, New York



COMMERCIAL REAL ESTATE SALES | LEASING | CONSULTING | DEVELOPMENT | MANAGEMENT

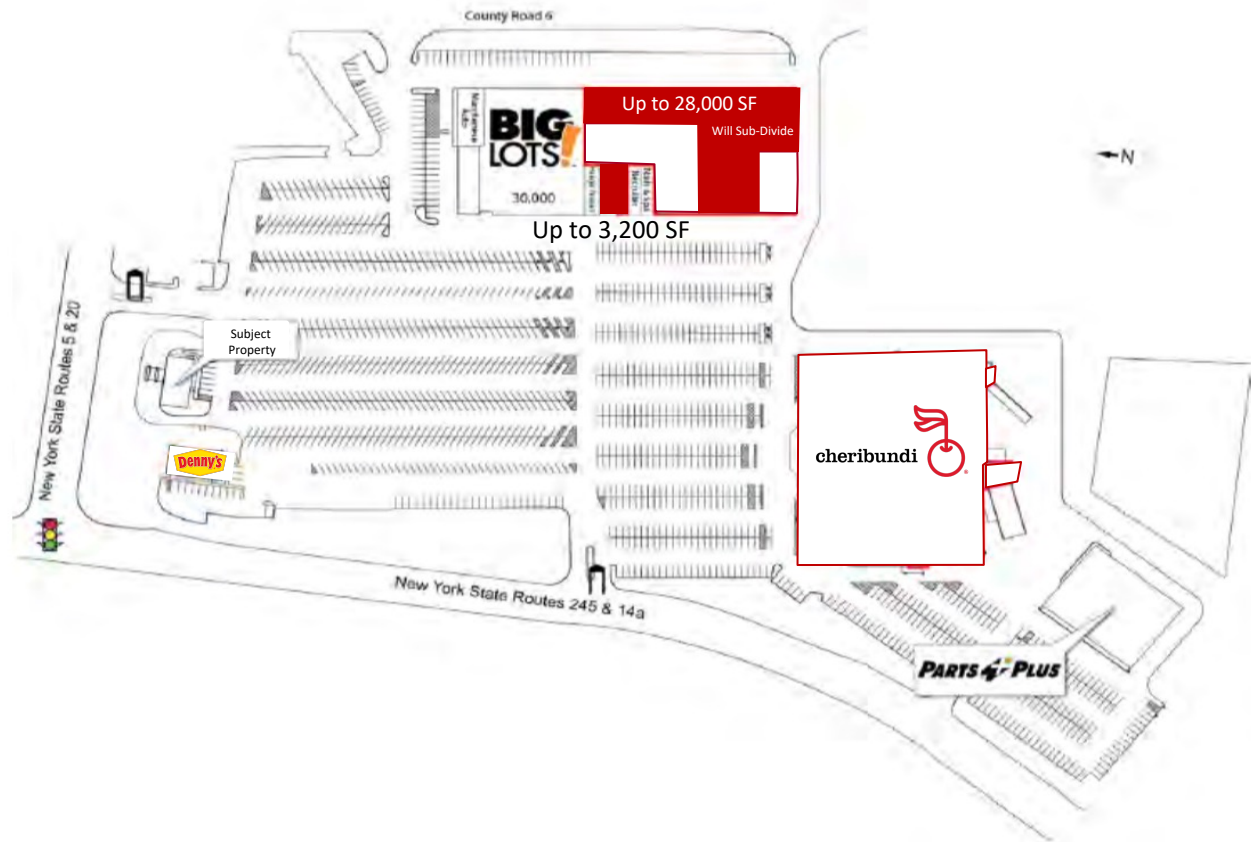

 Vacant



5 Oxford Road
New Hartford, New York 13413

151 Northern Concourse
Syracuse, New York 13221

PaviaRealEstate.com